

Good afternoon, CMLC Volunteers!

I hope you all are excited about this new month and the official approach of Spring just as much as I am :)

I have some wonderful upcoming opportunities, most provided by Kate Lis, Stewardship Associate Extraordinaire. You can read this email as below or read the attached pdf.

The outline of this email includes:

1. Tabling event on Thursday, March 16th
2. Request for materials to build bat rocketboxes
3. Workday to build previously mentioned bat rocketboxes on Saturday, March 25th
4. Blue bird monitoring volunteers needed – only a few needed so first come first served

The attached pdfs include:

- a. This whole email in pdf form
- b. Kate's request for materials without other parts of this email
- c. Kate's blue bird monitoring request without other parts of this email

1) Tabling event on Thursday, March 16th

CMLC will be tabling at the Kindergarten Readiness Rally on Thursday, March 16th from 10am until 7pm at the Blue Ridge Mall. Adrienne (Community Outreach Associate) and I will both be in attendance however it is a long day to be standing at a table and we would greatly appreciate if we could have some volunteers come and assist to allow Adrienne and I time for breaks such as a lunch (i.e. probably eating lunch behind the table but in front of the table while talking). Also I need to leave Adrienne around 4pm so if a volunteer could help Adrienne 4-7pm that would be fantastic. We will be doing some sort of educational and engaging activity. Please email me if you are interested.

2) Request for materials to build bat rocketboxes

See below for Kate's request:

Hi all!

Carolina Mountain Land Conserving is hoping to have a workday to help out our local bats by building bat habitat boxes! These man-made bat boxes are important substitute homes due to declining forests, changing forest management, and therefore, less available snags and trees to roost in. Bat boxes require some material that we just haven't been able to gather yet. If you have any of the following materials already lying around, please let CMLC know! We have several properties we want to create bat "real-estate" on, and we hope to make as many boxes as possible.

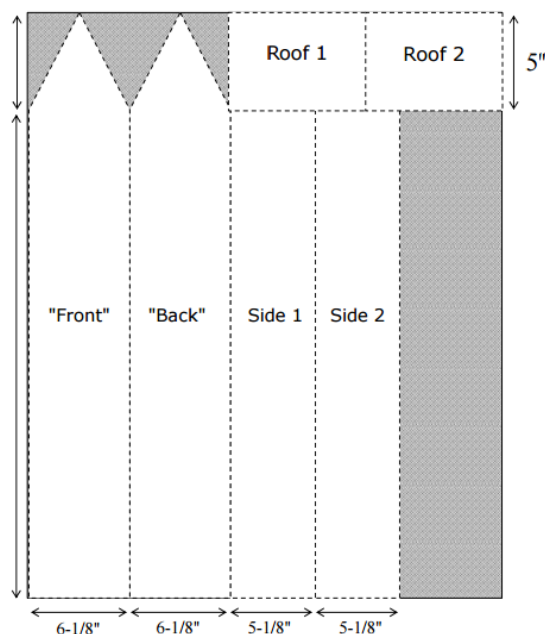

The ingredients are:

- 4"x4" untreated cedar, locust, or oak post (we need the boxes to be at least 10 ft out of the ground, and untreated where the bats will be roosting, but we can stack untreated and treated posts to achieve desired height – see included diagrams)
- ½" or larger lumber (hardwood preferred, but poplar or pine is fine) The length can vary, but we hope to get 6-1/8" wide pieces for front/back of boxes, 5-1/8" for sides, and 5" wide board for roofs (these are the specific widths for the bat design, which is very particular to bat box size preference)
- Small amount of shingle roofing (optional)

These other items are needed but we already have some available (more couldn't hurt if you have extra)! Wood caulk, galvanized screws, and lug bolts to attach wood posts.

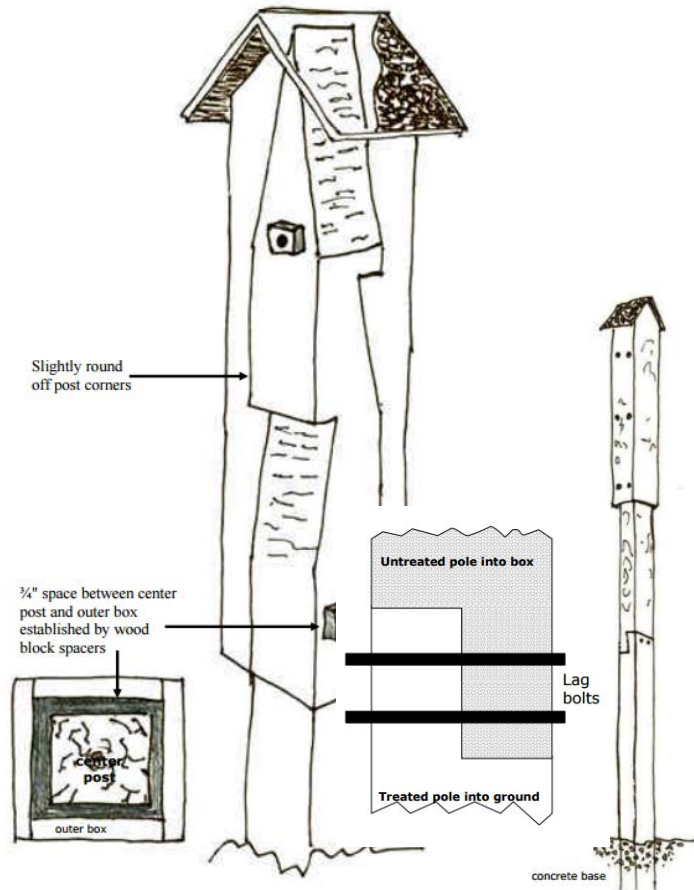

Contact Kate with any materials you have to offer or other creative solutions! We want to use anything that you already have but isn't in use (mission: reuse recycle). We can get creative with materials – please let me know what you may have lying around the yard or garage already!

Thanks so much.

CMLC Stewardship



Kate Lis
Stewardship Associate
AmeriCorps Project Conserve
kate@carolinamountain.org
Carolina Mountain Land Conservancy
847 Case Street
Hendersonville, NC 28792
<http://www.carolinamountain.org>
Phone: 828.697.5777 ext. 219

3) Workday to build previously mentioned bat rocketboxes on Saturday, March 25th

When: Saturday, March 25th 10am until around 4pm

Where: CMLC Office (847 Case Street Hendersonville, NC 28792)

What: Building bat rocketboxes with the donated materials

Why is this important work: To provide bats habitat – especially important with loss of habitat and other threats decreasing bat numbers. Bats play a very important role in our Western NC ecosystem!

What skills necessary to help: Use of hand tools helpful but not necessary. Also helpful if you have any tools you can bring (contact Kate).

How to attend: RSVP to this email so I can tell you any remaining details for the day

4) Blue bird monitoring volunteers needed – only a few needed so first come first served

See below for Kate's message:

Hi all,

Currently there are bluebird nest boxes out at two of our properties, and we need 2-3 more volunteers to help with the nest box monitoring!

What is your preferred time commitment for the nest box monitoring?

We need the boxes checked *once every week mid-March through August.*

This link is very good at explaining what to expect with the monitoring -

<http://www.sialis.org/monitoring.htm>. Sialis gets pretty detailed – so do not expect the same in-depth responsibilities. If we have any problems to solve we may be learning a lot, but no need to bring all the equipment they recommend – we'll have you monitor and report back to CMLC if you see anything worrisome (wasps, other residents, signs of squirrels widening gap etc.)

What the monitoring entails:

Bring a stool to be able to open nest box. I will make a mirror stick for you to view into nest from below (the boxes are ~7-8 ft high).

Approach the box as you hum, whistle, make some noise to minimize the startling effect on the possible residents. You'll observe before the nests are built, after the birds lay, you'll see the young grow into fledglings if all goes well, and hopefully you'll find no unwelcome visitors!

<http://www.thebsp.org/how-to-monitor-your-nestboxes.html> is another good source for monitoring basics.

Please contact me so we can discuss further if this volunteer opportunity will work for you!

Thanks,

Kate Lis

kate@carolinamountain.org

What a wonderful opportunities! Spring is going to be an amazing time of year filled with more volunteer opportunities (such as a continuation of the bat workdays) so that means I will probably be gracing your email inbox more :)

Hope you can lend our wonderful creatures of Western North Carolina a helping hand. Especially this adorable Eastern Pipistrelle bat!



So for now I'll just say see you later!



Madison Olle

Volunteer and Community Engagement Associate

AmeriCorps Project Conserve Member

Carolina Mountain Land Conservancy

847 Case Street

Hendersonville, NC 28792

Phone: 828.697.5777 ext. 211

Email: madison@carolinamountain.org

www.carolinamountain.org

"Unless someone like you cares a whole awful lot, nothing is going to get better. It's not." –The Lorax